

Lenovo Yoga AIO i (27",11)

Lenovo  
**YOGA**

Lenovo

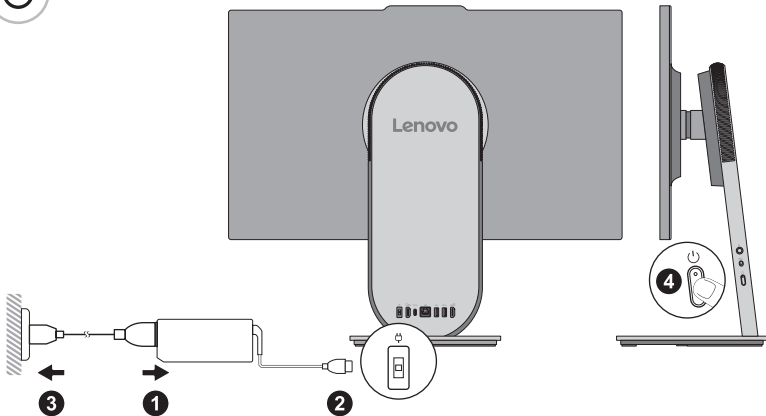



**i**

Turn to *User Guide* for USB transfer rates and more product information. |  
請參閱*使用手冊*以了解 USB 傳輸率以及更多產品資訊。|  
USB 転送速度および製品情報については、*ユーザー・ガイド*をご覧ください。|  
USB 전송 속도 및 추가 제품 정보에 대해 알아보려면 *사용 설명서*를 참조하십시오.

**\***

For selected models |  
選配 |  
一部のモデル |  
일부 모델의 경우



## Adjust the computer stand

調整電腦座架 | コンピューター・スタンドの調整 | 컴퓨터 스탠드 조정

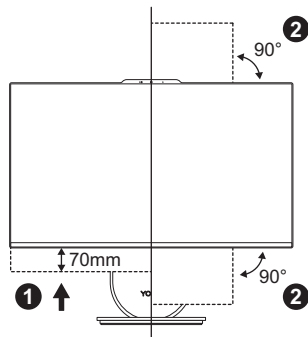
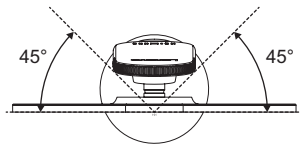
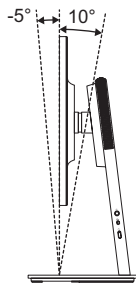



## Wireless charging\*

無線充電\* | ワイヤレス充電\* | 무선 충전\*

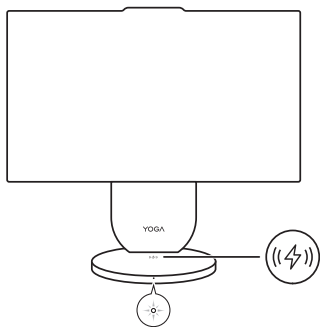

## One Cable Link

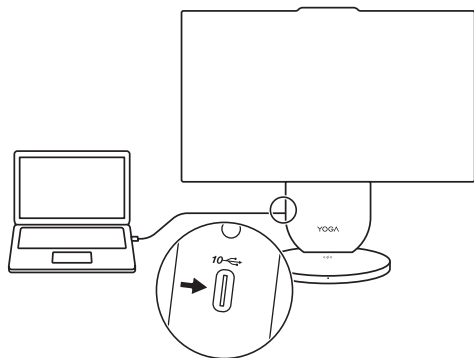



Screen extension | 螢幕延伸 | 画面の拡張 | 화면 확장

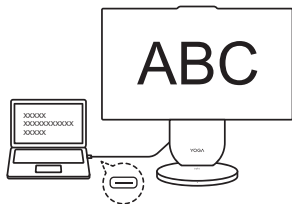

Reverse charging | 反向充電 | 리버스충전 | 역방향 충전

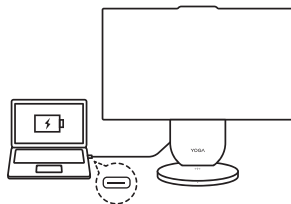

Speaker sharing | 共用揚聲器 | 스피커의 공유 | 스피커 공유



Keyboard and mouse sharing | 共用鍵盤和滑鼠 | 키보드와 마우스 공유

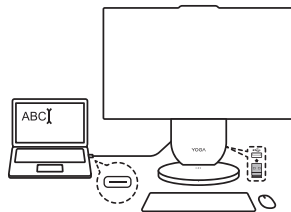



## User Guide Access

使用手冊存取 | ユーザー・ガイドへのアクセス | 사용 설명서 액세스

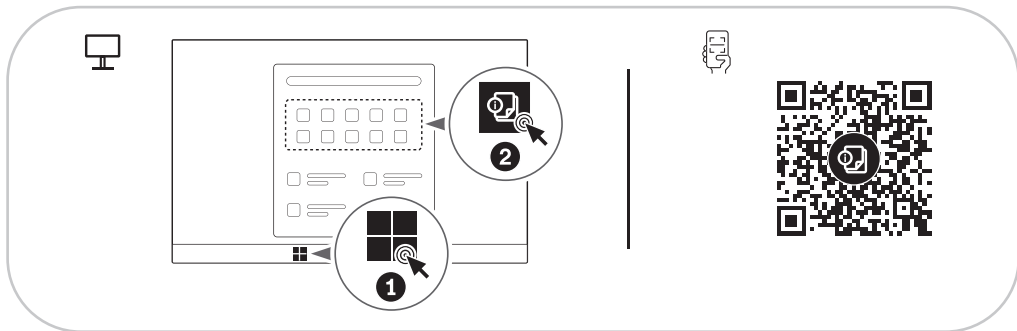

For Barcode Position Only

Printed in China  
PN: SP41M86152

Reduce  
Reuse  
Recycle



For FSC Mix logo only

First Edition  
(January 2026)

© Copyright Lenovo 2026.

LENOVO, LENOVO logo, Yoga, and Yoga logo are trademarks of Lenovo. The terms HDMI and HDMI High-Definition Multimedia Interface are trademarks or registered trademarks of HDMI Licensing LLC in the United States and other countries. USB-C is a registered trademark of USB Implementers Forum. All other trademarks are the property of their respective owners.

LIMITED AND RESTRICTED RIGHTS NOTICE: If data or software is delivered pursuant to a General Services Administration "GSA" contract, use, reproduction, or disclosure is subject to restrictions set forth in Contract No. GS-35F-05925.